

## PRODUCT CATALOGUE

# Sperm Freeze



- Medium for sperm cryopreservation.
- SF1 contains Egg Yolk as a cryoprotectant agent.
- SF3 contains rec-Human Albumin, long-chain alcohol<sup>(1)</sup>, and lipids<sup>(2)</sup> as cryoprotectant agents. Survival rate and motility rate with it are comparable to that of the conventional SF1 with Egg Yolk.
- Available in 0.5mL dispensed kits to simplify your procedure by aliquoting sample sperm only.
- The use of Sperm Freeze Board facilitates Sperm Freeze protocol.

(1) (2) Patented

REF	Code	Details	Contents
92209	SF1-10	Sperm Freeze with Egg Yolk	10mL
92208	SF1-05x5		0.5mLx5
92211	SF3-10	Sperm Freeze with Recombinant Human Albumin	10mL
92221	SF3-05x5		0.5mLx5

## COMPONENTS

Calcium DL-Lactate / Gentamicin / Glycerol / Glycine / Lauryl alcohol / Magnesium sulfate / Potassium chloride / Sodium bicarbonate / Sodium chloride / Sodium phosphate / Tocopherol / Trehalose / Tris /

SF1: Egg Yolk / SF3: Recombinant Human Albumin

## QUALITY CONTROL

pH 7.2-7.6 / Osmolality / Endotoxin <0.25EU/mL / Sperm Survival ≥80% / Sperm Cryosurvival ≥0.5 / Sterility Test  
 Storage: -20°C  
 Shelf Life: 18 months

## ACCESSORIES

REF	Code	Details	Contents
1505001	Tube-Cryo1.0(innercap)	1.0mL Cryotube	500pcs
84021	Sperm Freeze Board	Float with cryotube holders	2pcs/box
84030	Sperm Freeze Board Set	Styrofoam container and Sperm Freeze Board	1pc each/box

Specification may change without pre-notice for purpose of product improvement.

## Kitazato Corporation

HEADQUATER : 100-10 Yanagishima, Fuji, Shizuoka 416-0932 JAPAN

TOKYO : 1-1-8 Shibadaimon, Minato-ku, Tokyo 105-0012 JAPAN

[Mail contact@kitazato.co.jp](mailto:contact@kitazato.co.jp)

# PROTOCOL

## Freezing

- 1 Bring Sperm Freeze to room temperature (20-25°C) before use.
- 2 Fill a polystyrene box with Liquid Nitrogen to  $\geq 20$  cm depth and let Sperm Freeze Board float.  
Note: The use of a polystyrene box with a certain height keeps stable conditions during the sperm freeze by reducing influence from the outside air.
- 3 Mark cryotubes with patient ID.  
Prepare 0.5mL of washed sperm / liquefied semen and equal volume of Sperm Freeze in the cryotubes, and mix well while avoiding making bubbles.
- 4 **(A)** Set the cryotubes on the Sperm Freeze Board.  
Cover the polystyrene box with a lid to reduce the influence of outside air.  
**(B)** When attaching cryotubes to a cane and laying them on the Sperm Freeze Board, reduce the amount of liquid nitrogen so that the freezing solution does not contact with the lid of the cryotube.
- 5 After 5 minutes, remove the cryotubes from the Sperm Freeze Board and place them into liquid nitrogen. Then transfer the cryotubes to a liquid nitrogen tank for storage.

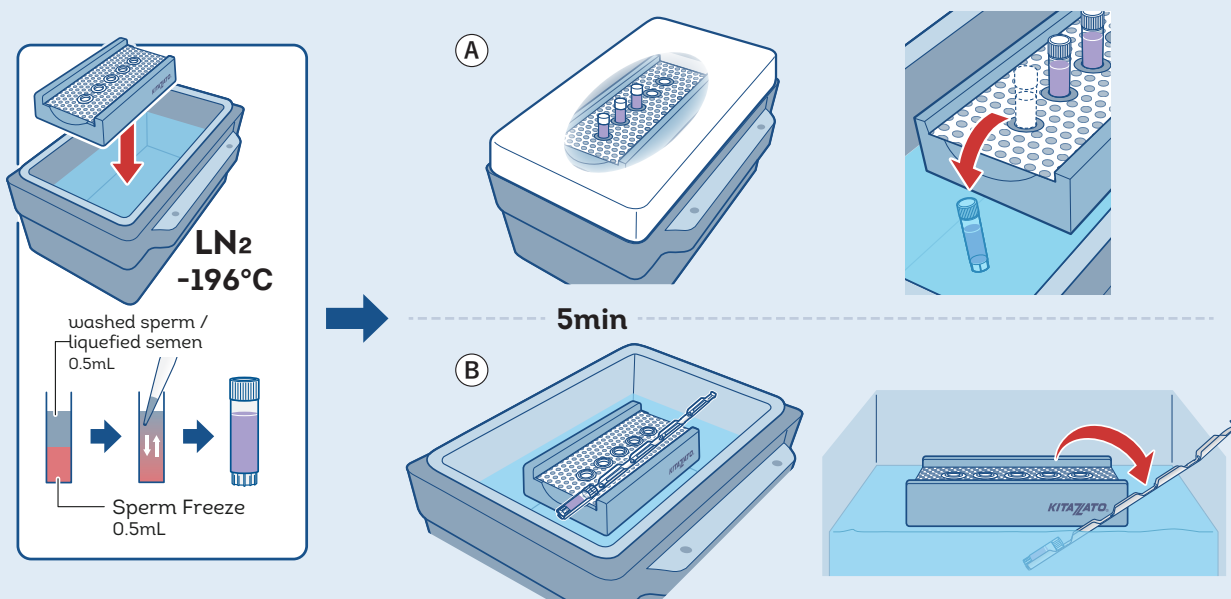

## Thawing

- 1 Remove the cryotubes from the liquid nitrogen tank and place them in a waterbath at 37°C for 5-10 minutes to thaw.
- 2 Mix the sperm sample slowly. Perform sperm analysis test and follow your laboratory procedures for the subsequent sperm preparation.

## RELATED PRODUCTS

- Sperm Freeze Board (REF : 84030)